

CDIT-1 Stainless Steel Low Profile Compression Load Cell

Description

The CDIT-1 series of load cells has been designed for a wide range of force measurement and weighing applications where space is limited. The CDIT-1 is constructed from stainless steel and has a fully welded construction, offering a high level of corrosion resistance making it suitable for use in harsh environments.

Available in ranges covering 0-100kg to 0-5000kg, there are many applications ideally suited to the CDIT-1, including restricted height weighing applications, general force measurement and press calibration.

LCM Systems can provide the CDIT-1 on its own or combined with any of our instrumentation range, to offer a more complete package. Please consult our technical department for any advice required on suitable instrumentation solutions.

Specification

Rated load (kg)	100, 250, 500, 1000, 2500, 3500, 5000
Overload range	150% full scale output (FSO)
Ultimate breaking load	>300% FSO
Output	2mV/V ($\pm 0.2\%$)
Zero balance	$< \pm 1\%$ FSO
Non-linearity	$< \pm 0.2\%$ FSO
Non-repeatability	$< \pm 0.05\%$ FSO
Excitation voltage	10vdc recommended (18vdc maximum)
Input resistance	400 Ω \pm 20 Ω
Output resistance	350 Ω \pm 2 Ω
Insulation resistance	>5G Ω @50vdc
Compensated temperature range	-10 to +40°C
Operating temperature range	-20 to +70°C
Storage temperature range	-20 to +80°C
Zero temperature coefficient	$< \pm 0.03\%$ FSO/°C
Span temperature coefficient	$< \pm 0.025\%$ FSO/°C
Environmental protection level	IP67
Electrical connections	Glanded PVC cable, 3 metres long
Wiring connections	+ve supply: Red -ve supply: Black +ve signal: White -ve signal: Yellow

Available Options

- TEDS option (when used with TR150 handheld display)

Features

- Ranges: 100 to 5000kg
- Low height/profile
- Stainless steel construction
- Environmentally sealed to IP67

Typical Applications

- Process measurement & control
- Automotive testing
- Low profile weighing systems

AVAILABLE TO BUY ONLINE

Visit our website www.lcmsystems.com
(In-stock items usually ship within 48 hours)

LCM Systems Ltd

Unit 15, Newport Business Park
Barry Way, Newport
Isle of Wight PO30 5GY UK
Tel: +44 (0)1983 249264
Fax: +44 (0)1983 249266
sales@lcmsystems.com
www.lcmsystems.com

CDIT-1 Stainless Steel Low Profile Compression Load Cell

Dimensions

0-100kg to 0-2500kg

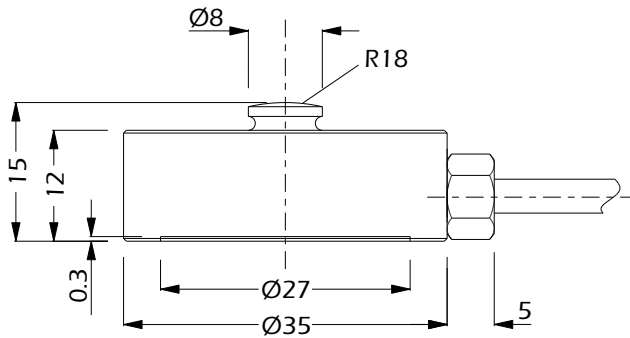

All dimensions are in mm

0-3500kg and 0-5000kg

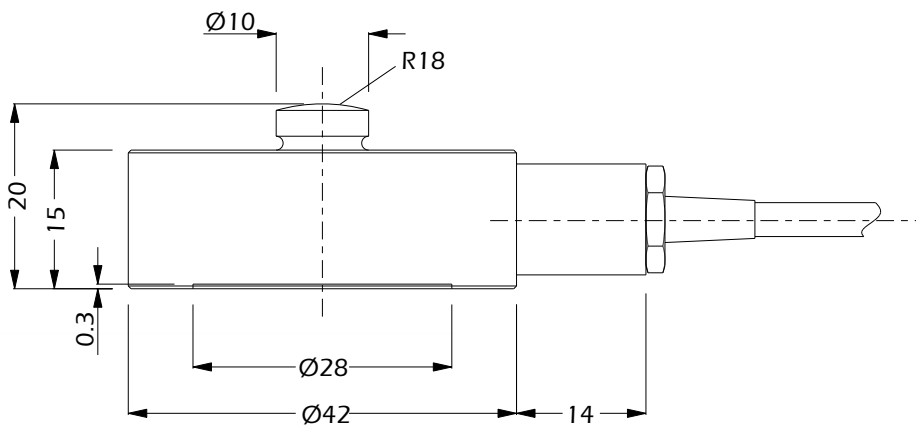

Rating (kg)	Part Number	Weight (g)	Resolution (kg)
100	CDIT-1-100	130	0.1
250	CDIT-1-250	130	0.2
500	CDIT-1-500	130	0.5
1000	CDIT-1-1000	130	1
2500	CDIT-1-2500	130	2
3500	CDIT-1-3500	200	2
5000	CDIT-1-5T	200	5

