

Load Rating: 3 Tonne  
 Proof Load: 6 Tonne  
 Safety Factor: 10:1  
 Expected Output: 0.5 mV/V  
 Sealed To IP65

Bridge Resistance: 1000 Ohm

2 Off Crosby 6.5 Te G2130 Shackles  
 Also Supplied.

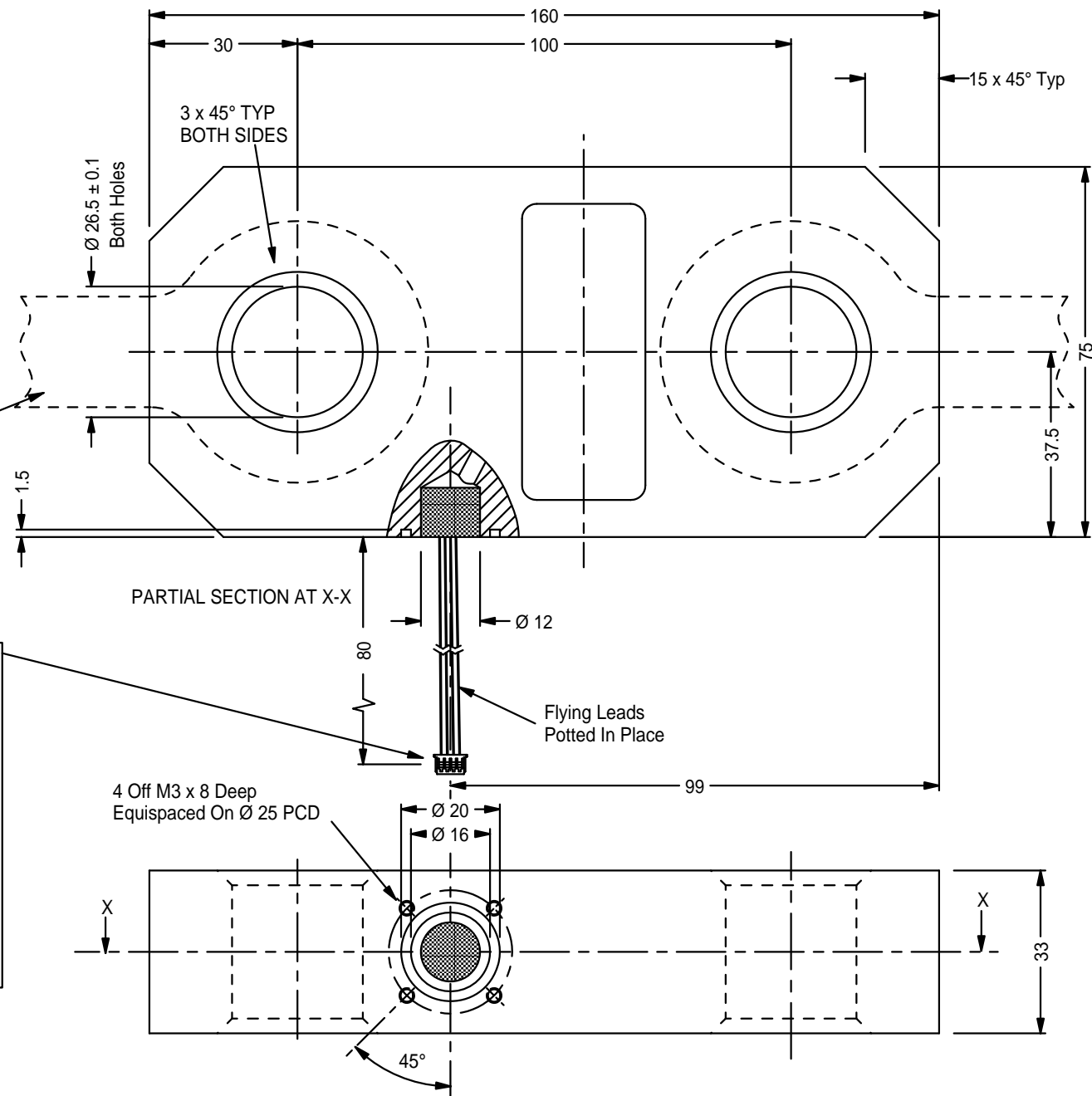

Molex 51021-0400 4 Way Connector +  
 4 Off 50079-8000 Crimp Contacts

Wiring Details:  
 Pin 1 Red (+Supply)  
 Pin 2 Green (+Signal)  
 Pin 3 Yellow (-Signal)  
 Pin 4 Blue (-Supply)

Pin 1 Ident

DO NOT SCALE  
 IF IN DOUBT ASK



DIMENSIONS IN  
 MILLIMETERS

TOLERANCES UNLESS STATED

GENERAL SURFACE	3.2	FABRICATIONS/CASTINGS
UP TO 10mm	+/-0.1	UP TO 600mm +/-1.0
FROM 10mm to 100mm	+/-0.25	OVER 600mm +/-2.0
OVER 100mm	+/-0.5	REMOVE SHARP EDGES
ANGULAR DIMS	+/-1°	

TITLE: **Load Link**

ISSUE: A

DRAWN BY: AB

DATE: 25/01/10

MATERIAL: 17-4PH COND A

FINISH: N/A

CHANGE: INITIAL ISSUE



LCM Systems Ltd  
 Unit 15 Newport Business Park  
 Barry Way  
 Newport  
 Isle of Wight  
 PO30 5GY  
 Tel: 01983 249264 Fax: 01983 249266

DRG NO: **LCM 3770**